

LAY OUT PLAN OF GOVT. TEACHERS TRAINING INSTITUTE FOR WOMEN GURDASPUR

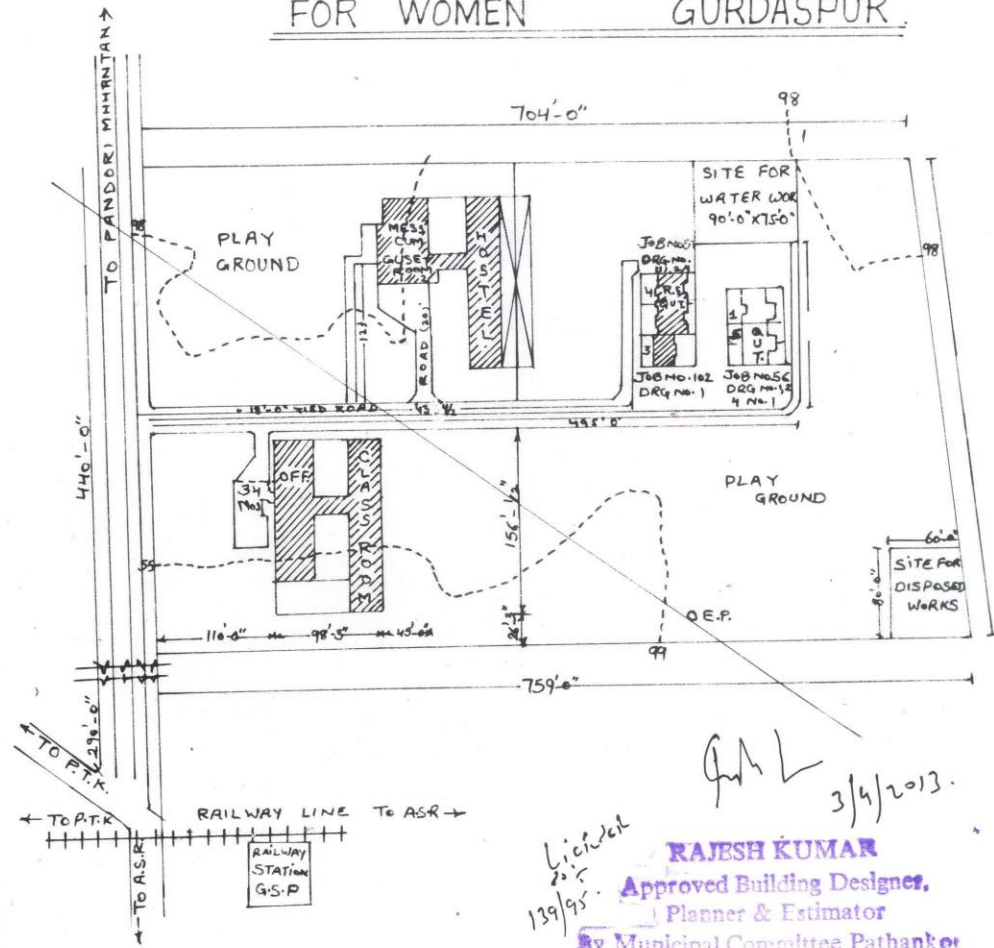

PROP. BUILDINGS ASS.	
ROADS	
FOOT PATH	
TOTAL AREA = 311700 SQ. FT.	
1. TEACHING BLOCK	
2. HOSTEL BLOCK	
3. 1 No'S 1200 SQ. FT. MOD.	
4. 4 No'S 600 SQ. FT. HOUSE	
5. 4 No'S 400 SQ. FT. HOUSE	
LAY OUT PLAN SCALE :- 1" = 40'-0"	
DRAWN BY :-	
GOVT. TEACHERS TRAINING INSTITUTE FOR WOMEN. GURDASPUR - 143521	

3/4/2013.

RAJESH KUMAR
 Approved Building Designer,
 Planner & Estimator
 By Municipal Committee Pathankot
 CIVIL COURT, PATHANKOT